



Moisture  
Management  
for Masonry

Product:	<b>TotalFlash®</b>
Manufacturer:	<b>Mortar Net Solutions™</b> 6575 Daniel Burnham Drive, Suite G Portage, IN 46368 (p)- 1-800-664-6638 (f)- 1-219-787-5088 info@mortarnet.com

Date:	
Project :	
Location:	

<b>Credit MR4.1 and 4.2: Recycled Content</b>	Drainage Mesh
Percentage of Pre-consumer <sup>1</sup> Recycled Content by Weight:	40%
Percentage of Post-consumer Recycled Content by Weight:	

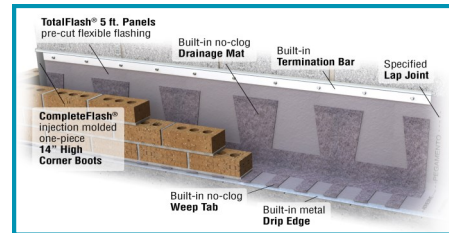

Product Composition Material:	Percentage of Material by Weight:	Manufacturing Location:
Polyester Fiber	54.3%	Columbia, SC (Richland)
Water-borne Polymer	45.7%	Cleveland, OH (Cuyahoga)

<b>Credit MR4.1 and 4.2: Recycled Content</b>	PVC Termination Bar
Percentage of Pre-consumer <sup>1</sup> Recycled Content by Weight:	100%
Percentage of Post-consumer Recycled Content by Weight:	

Product Composition Material:	Percentage of Material by Weight:	Manufacturing Location:
Termination Bar	100%	Los Angeles, CA 90001

<b>Credit MR4.1 and 4.2: Recycled Content</b>	Rubberized Asphalt
Percentage of Pre-consumer <sup>1</sup> Recycled Content by Weight:	N/A
Percentage of Post-consumer Recycled Content by Weight:	N/A

Product Composition Material:	Percentage of Material by Weight:	Manufacturing Location:

<b>Credit MR4.1 and 4.2: Recycled Content</b>	Stainless Steel Drip Edge
Percentage of Pre-consumer <sup>1</sup> Recycled Content by Weight:	
Percentage of Post-consumer Recycled Content by Weight:	80%

Product Composition Material:	Percentage of Material by Weight:	Manufacturing Location:
Stainless Steel		Ghent, KY

12/04/2014 GS