

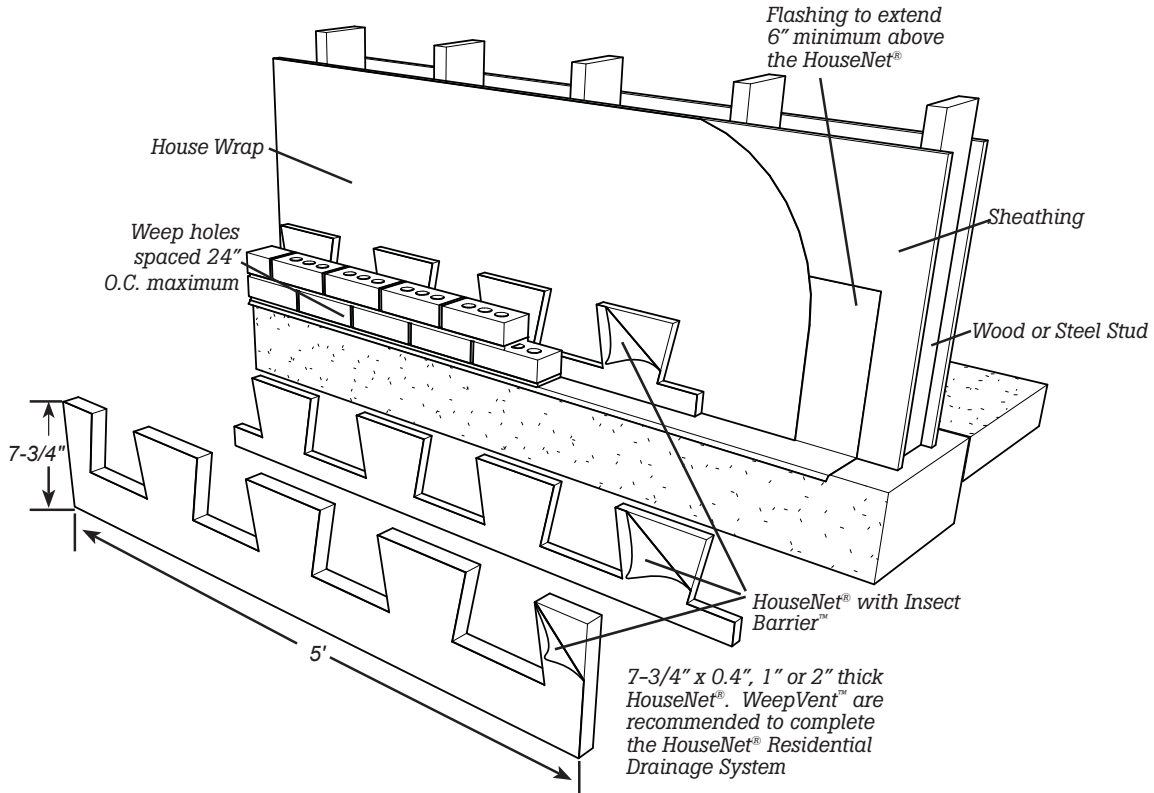

This package contains **0.4", 1" or *2" HouseNet®**
80 LF of .4", 1" or 2" HouseNet®

Installation Instructions

1. Fast and easy to use - no fasteners or adhesives, no special skills or tools. After the first one to two courses of bricks are laid, place a continuous row of HouseNet® in cavity or collar joint on flashing (*trapezoidal side up*) against inside of outer wythe at base of wall (**see diagram**).
2. Install HouseNet® **directly on flashing** at base of wall, above doors, windows, and other openings, and flashed areas.
3. Install HouseNet® at every floor level. For wall-cavities that exceed 9' in height, place an additional continuous trapezoidal strip on wall reinforcing anchors/ties at every 9' of wall height.
4. Flashing should extend from bottom to 6" above the top of HouseNet®.
5. HouseNet® should touch both cavity surfaces - **trapezoidal side up**. HouseNet® is compressible to allow for variations in wall-cavity widths.



HouseNet® is compressible to allow for variation in wall cavities. It must be used in conjunction with impermeable through wall flashings that are recommended by the flashing manufacturer for that use. HouseNet should be installed only by experienced masons in properly specified weep hole/flashing systems.

*2" HouseNet® not available with Insect Barrier. HouseNet® with Insect Barrier™ is patented, US Patent Reissue #36676

For Technical Support:
Please Call 1-800-664-6638

Moisture Management for Masonry
326 Melton Rd., Burns Harbor, IN 46304
P 800 664 6638 F 219 787 5088
www.mortarnet.com

