



Moisture
Management
for Masonry



TOTALFLASH® MASONRY CAVITY WALL DRAINAGE SOLUTION IT'S MUCH MORE THAN JUST FLASHING

Cuts flashing system installation time. Helps keep veneer walls dry.

The patented TotalFlash Cavity Wall Drainage Solution is a complete, factory-assembled masonry cavity wall flashing system. It combines a flashing membrane with a mortar dropping collection drainage mat, weep tabs, drip edge and termination bar into a single, easy-to-install panel. It provides superior moisture protection, slashes labor costs, and can be custom configured for your job, usually at no additional charge.

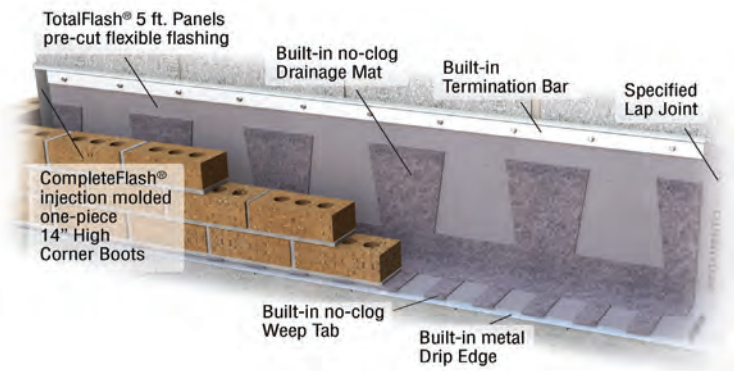

Features

- Sold in boxes of 10 pre-assembled 5' 6" panels (5' net/panel, 50' net/box)
- 90% open-weave polyester mesh mortar dropping collection mat and weep tabs
- 18" standard height
- Additional available sizes are 12", 24" (Custom sizes available on request)
- Customizable with 5 membranes, 6 drip edges, and 3 termination bars
- FREE takeoff service on awarded jobs, custom panel sizing and bid and installation help

Benefits

- Proven to cut installation time by at least 50% vs. field installed through wall flashing pieces and parts
- FREE takeoff service on awarded projects guarantees
- One stop shopping means no job slow-downs waiting for separate items to be delivered
- Significant reduction in flashing installation time and expense on large projects by using 50' rolls for long runs combined with pre-assembled panels custom-sized for repetitive openings
- Proven overlap and termination method quickly and easily creates air- and water-tight lap joints and terminations
- Termination bar has pre-drilled holes every 6 inches for easy installation
- Integrated weep tabs will not clog from mortar droppings and prevent insects from entering the cavity
- Ideal for restoration projects with a variety of standard and custom sizes
- Clear instructions, extensive product support, simple, fast installation and high quality materials helps assure leak-proof installations to specs

CompleteFlash™ 14" inside/outside preformed High Corner Boots and end dams, preformed metal 90° outside drip edge corners, metal adjustable drip edge corners, and BTL-1 sealant sold separately.